

CHANGES		APPR. BY:
REV. 1	ECN #111	JPC
ADDED ALL DOMINATOR AND LCD MODELS: DIM "A" ON #03-1652 WAS 5"		JPC
		JCB

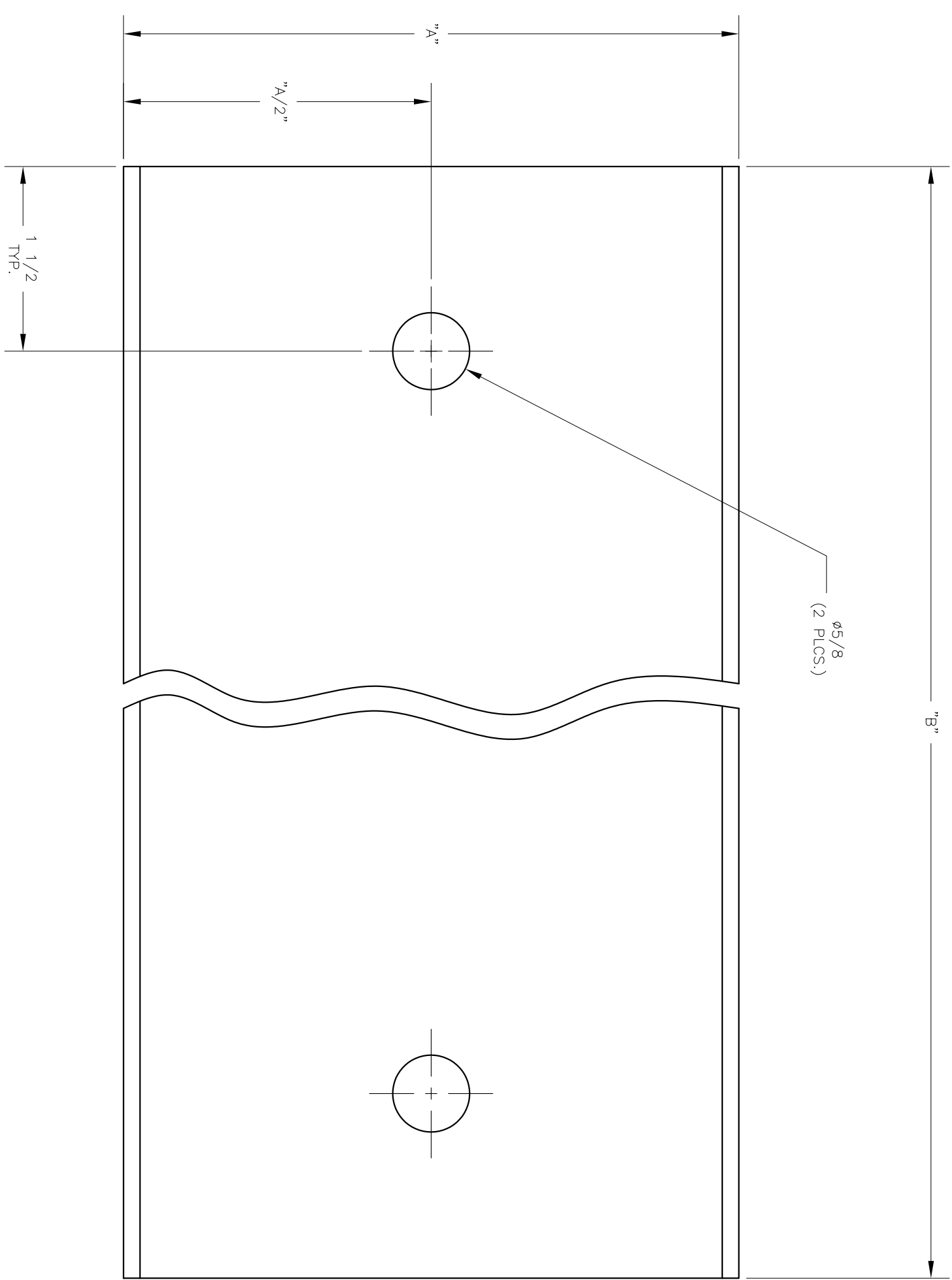

PART #	MODEL	DIM. "A"	DIM. "B"
03-1651	500	3"	28"
	750		
	1000		
	1250		
03-1652	1500	4 1/2	36"
	1750		
	1950		
DOM ALL			
LCD ALL			

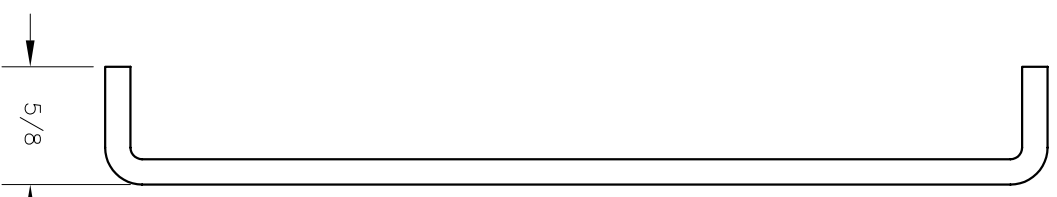

NOTES:

1. MATL: 10 GA. (.1345) C.R.S., PAINTED.
2. 03-1652 SHOWN.

TOLERANCES
(UNLESS OTHERWISE SPECIFIED)
± 1/32 ON FRACTIONAL DIM'S.
± .005 ON DECIMAL DIM'S.
DRAFT: Z MAX (SEE NOTE 2)
± .25° ON ANGLE DIM'S.

THIS PRINT AND ALL INFORMATION APPEARING THEREON IS THE PROPERTY OF WESTEK CORPORATION. IT IS TO BE KEPT IN CONFIDENCE AND NOT BE REPRODUCED OR USED IN ANY MANNER WHATSOEVER OR DIVULGED TO ANY OTHER PERSON UNLESS SPECIFICALLY AUTHORIZED BY WESTEK INC.



FUTERA II &
DOMINATOR/LCD
SEISMIC MOUNTING STRAP

SCALE: FULL	DATE: 05-16-01	DWG. SIZE: B	DRAWING NUMBER: 03-1651	R
DR. BY: JCB	10-16-01		03-1652	E
CK. BY: JPC				1