

**Model HK13
Portable Heat Pump
Submittal Data**



SD-HK13-1

STANDARD FEATURES

- 13,200 Btu Cooling Capacity
- 14,300 Btu Heating Capacity
- Spot-Cool / Room-Cool Thermostat Settings
- Internally Insulated with Fiberglass Insulation
- Thermostatic Control with Multi-Speed Fan
- Double Shaft Motor for Two Fans
- R410A Refrigerant
- Optional Easy Install Condensate Pump Kit with Overflow Protection
- 115V/1 Phase
- Directional Nozzles (2)
- Heavy Duty Twin Wheel Casters for Portability
- Auto Fan Speed Option
- Self-Diagnostic Function
- Off-Timer
- Washable Filters
- 2" Hot Air Exhaust Flange

SAFETY DEVICES

- Compressor Overload Protection
- Anti-freezing Thermistor
- Automatic Restart (Power Interruption)
- Compressor Time Delay Program
- High Pressure Sensor & Low Pressure Sensor



SPECIFICATIONS

Model Number	HK13
Cooling Capacity	13,200 Btu/hr
Heating Capacity	14,300 Btu/hr
Cooling Test Conditions	95°F
Voltage/Phase/Hz	115/1/60
Amperage Heating/Cooling	8.53/8.58
Fuse Size	15amps
LCDI Plug Configuration	NEMA 5-15
Power Cord Length	6'
Refrigerant Type	R410A
Dimensions	27L x 21W x 41H
Net Weight	190
Shipping Weight	196
Condensate Tank Capacity	4.75 Gal

ADDITIONAL SPECIFICATIONS

Ambient Temperature Range (Heating)	54-77°F
Ambient Temperature Range (Cooling)	64-113°F
Setting Temperature (In Temp Mode)	Cooling 64-113°F
	Heating 64-113°F
Setting Temperature (Out Temp Mode)	Auto 70-113°F
	Cooling 32°F
	Heating 122°F
Application Area Ft ² (Room Cool Mode)	Auto 70-113°F
	376
Refrigerant Type / Ounces	R410A / 52.2
Design Pressure High/Low	450 / 250 PSIG
Indoor Air Flow	470 CFM
Hot Air Duct Diameter	12"
Maximum Exhaust Duct Length	50'
Condenser Air Flow	490 CFM
FLA	15.5 Amps
Max Duct Length: Cold Air Supply	45 ft.
Max Duct Length: Hot Air Discharge	50 ft.
Duct Connection Hot Air Discharge	12 in.



**260 North Elm St.
Westfield, MA 01085
Phone: 413-564-5520**

www.Koldwave.com

Project: _____ Date: _____

Location: _____

Customer: _____

Engineer: _____

Submitted By: _____

For: Reference Approval Construction

Unit Designation: _____

Schedule Number: _____

Model HK13-Submittal Data

CONTROL PANEL

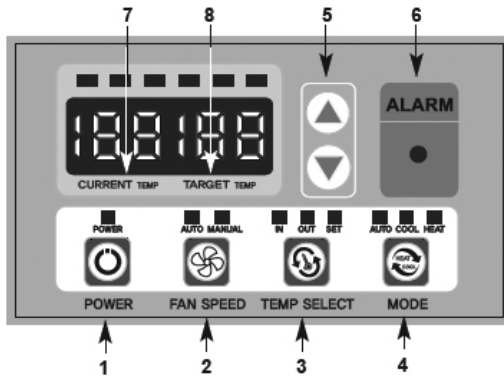

Control Panel Key Buttons:

1. Power
2. Blower Speed
3. Temp Select
4. Change Mode
5. Adjust setpoints
6. Alarm
7. Current Temp
8. Target Temp

COMPONENT PARTS

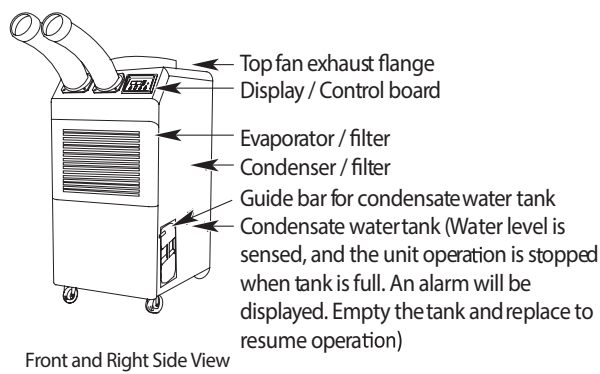

Front and Right Side View

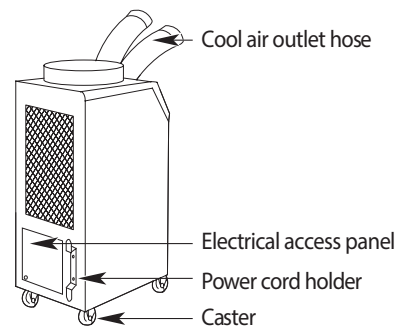

Back and Left Side View

DIMENSIONS (In Inches)

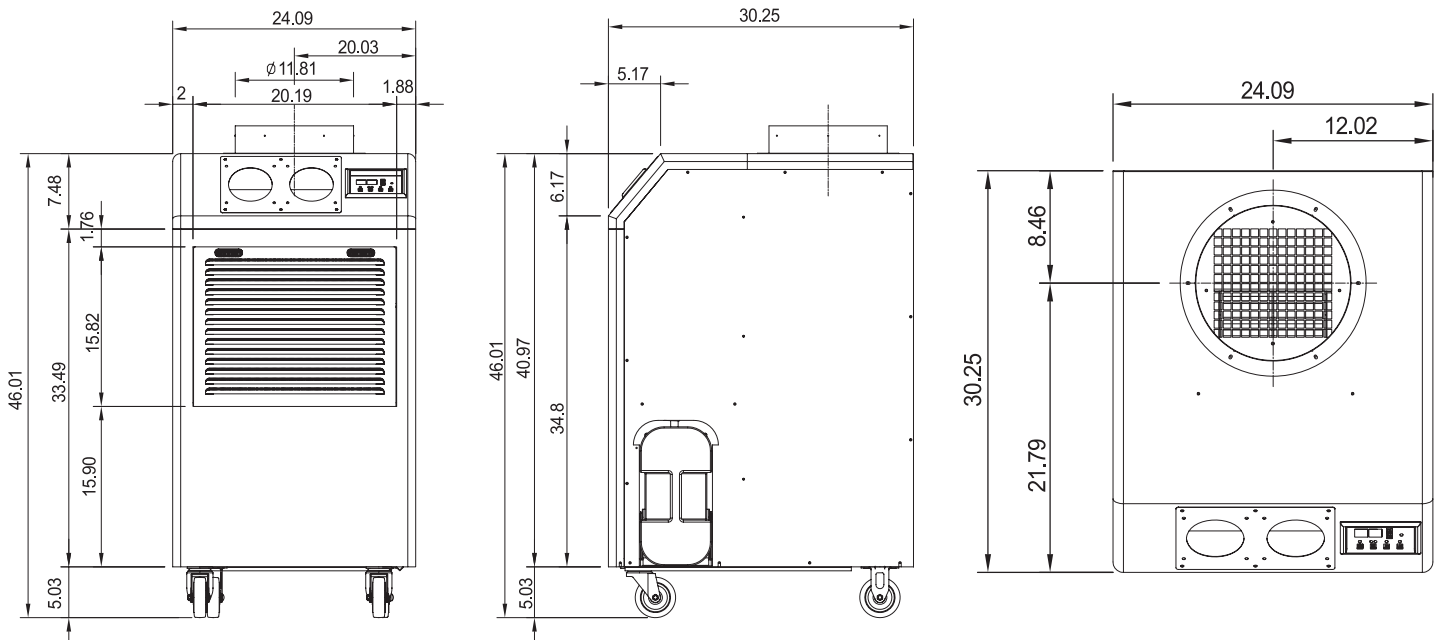

ASSEMBLY

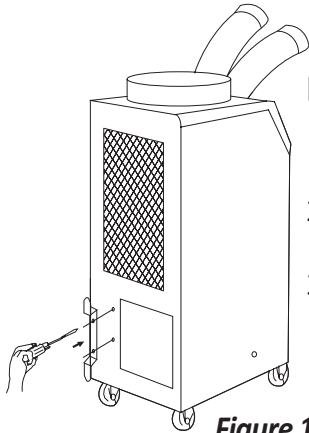

POWER CORD HOLDER

1. Take out the cord holder from the accessory box.
2. Place the cord holder on the back side of the unit
3. Use screws (enclosed inside of accessory box with cord holder) to install the cord holder on the air conditioner as shown in Figure 1.

Figure 1

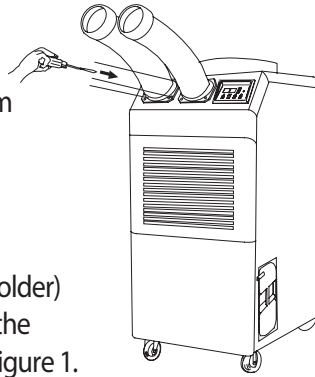

DISCHARGE DUCTS/SUPPLY AIR DUCT

1. Remove cool air outlet hose(s) from carton.
2. Place the cool air outlet hose(s) on the front top of the unit
3. Use screws (enclosed inside of box with cool air outlet hose(s)) to install the cool air outlet hose(s) on the unit as shown in Figure 2.

Figure 2

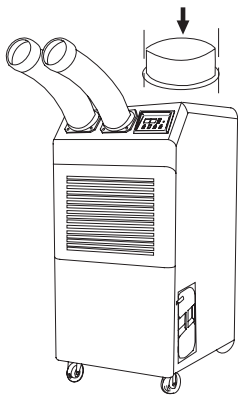

TOP FAN EXHAUST FLANGE

1. Remove the top fan exhaust flange from carton.
2. Place the top fan exhaust flange on the top of the unit.
3. Use screws (enclosed inside of box with the top fan exhaust flange) to install the top fan exhaust flange on the unit as shown in Figure 3.

Figure 3

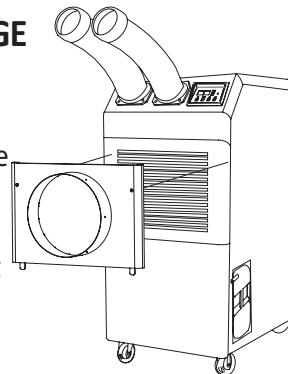

EVAPORATOR PLENUM (Optional)

An evaporator plenum can be purchased separately. Plenum fits over the evaporator to duct evaporator air to the unit to improve cooling efficiency.

1. Remove the evaporator cover from the unit.
2. Remove the filter from the evaporator cover and put it into the plenum.
3. Install the plenum in front of the evaporator.

Figure 4

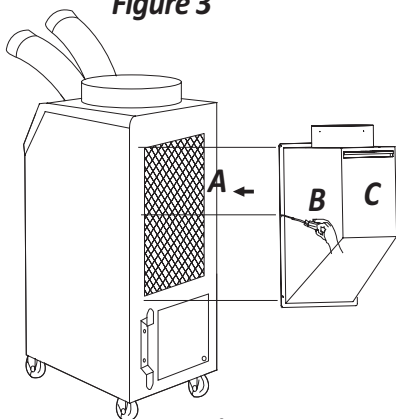

CONDENSER PLENUM (Optional)

Condenser plenum can be purchased separately. Condenser plenum fits over the condenser to duct condenser air to the unit to improve cooling efficiency.

1. Remove the Filter("A")
2. Check the Filter("C") is inserted properly in Condenser plenum("B")
3. Install "B" which contains "C" by using driver with enclosed bolts (6ea.) as Figure 5.

Figure 5

Model HK13-Submittal Data

Accessory Parts

Part Name	Part Number
Condensate pump kit (115V)	SA057-0072
Condenser plenum/return air adapter	KWPHPLENUM-3000
Remote Controller (26 ft with line)	SA076-4006
16 FT Temperature Sensor	SA076-4007
Cool air duct connecting flange (D5", L3")	SA076-4008
Long cool air duct assembly (D5", L40")	SA076-4009
Replacement washable filter, evaporator	KWPCFLT-03E
Replacement washable filter, condenser	KWPCFLT-03C