

Backdraft Damper • 7½" Deep • Single Thickness Blade • Round Frame • Galvanized Steel • -35°F to 180°F Temperature

**Standard Construction and Materials**

- FRAME:** 16 GA. galvanized steel, 7½" deep.
- BLADE:** 16 GA. galvanized steel, reinforced for frames over 18" dia.
- AXLE:** ½" dia. plated steel stub.
- BEARINGS:** Flange oilite bronze.
- SEALS:** On frame, ¼" thick closed cell neoprene. Temperature range is -35°F to 180°F.
- FINISH:** Mill.

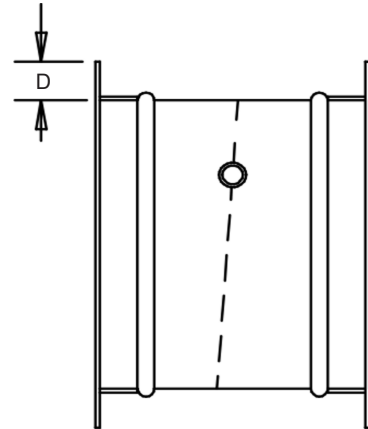

Equal leg angles are available. They are welded to frames at intermittent spacing and caulked between welds. Flange Height "D" varies with damper diameter.

**Options**

Counter balance - mounted to blade or installed on extended shaft.

**Notes**

1. Nominal deductions will be made to the opening size given.
2. Please contact the factory for damper sizes larger than 36" diameter.
3. When ordering a counter balance, please specify type: assist or resist opening.
4. Damper sizes of 12" dia. and less shall have a counter balance located on an extended shaft only.
5. To calculate approximate shipping weight (lbs./in.), use following formula:  
 Damper Circumference (Diameter [in.] × 3.141) × 0.5

**Damper Sizes**

Minimum Size	Maximum Size
4" O.D.	36" O.D.

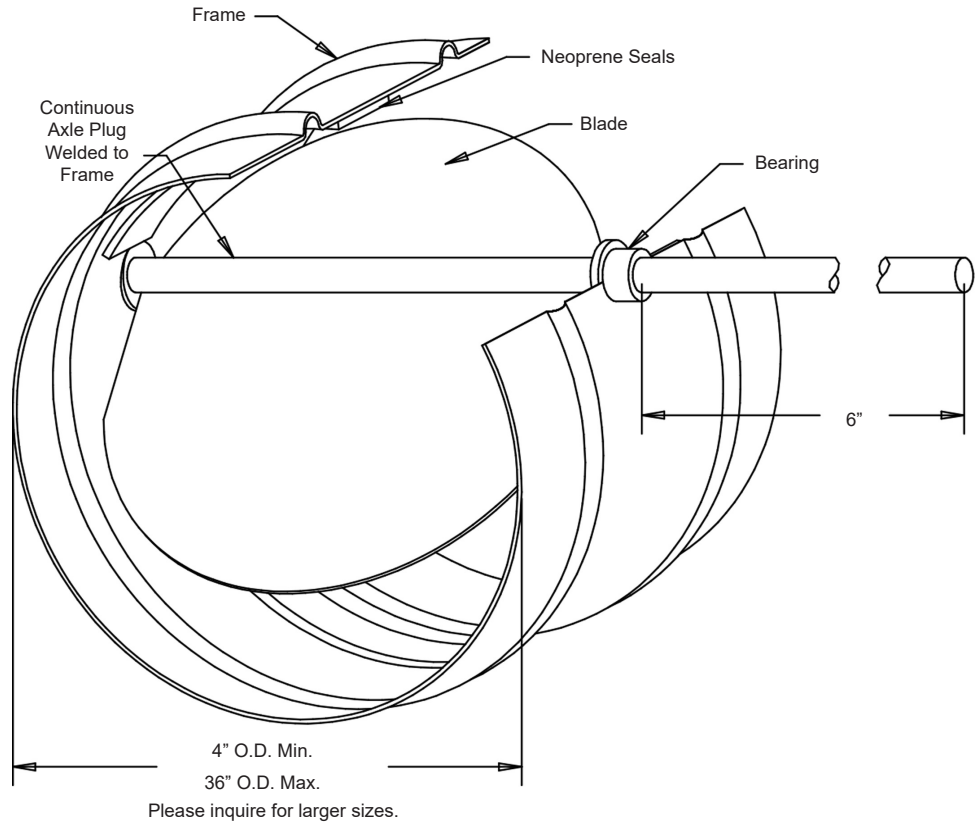

						 Union Made	
Item #	Qty	Damper Size O.D.	Assist	Resist	Remarks		
			Counter Balance				
Arch. / Eng.:		EDR:		ECN:	Job:		
Contractor:		Date:		DWN:	DWG:		
Project:							

In the interest of product development, Cesco Products reserves the right to make changes without notice.



450 Riverside Dr • Wyalusing PA, 18853  
 Phone: 570-746-1888 • Fax: 570-746-9286  
 www.cescoproducts.com