

# MODEL ESV-28

Equipment Screen Louver • 4" Deep • "Y" Shape Blades • Vertical • Sight Proof • Extruded Aluminum

### Standard Materials and Construction

**FRAME:** .081" thick (nominal) extruded aluminum 6063-T52/T6 alloy.

**BLADE:** .081" thick (nominal) extruded aluminum 6063-T52/T6 alloy.  
Blades spaced approximately 3" on center with architectural style hidden mullions.

**SUPPORTS:** Shall incorporate rear angle 2" x 2" x 1/4" extruded aluminum to withstand windload of 20 PSF, approximately 90 mph wind. Supports vary as required, per windload. Spaced approximately 60" on centers.

**FINISH:** Mill

### Options

Variations - Mitered Corner, Post Corner, Hinged Access, and Cap Covers.

Finishes - Kynar, Baked Enamel, Clear and Color Anodize (Consult the factory for details.)

### Notes

1. Maximum panel size should not exceed 60 sq. ft. or 120"W x 72"H. Louver sections larger than the factory maximum size will require field assembly of smaller sections.

2. Approximate shipping weight is 4.5 lbs./sq.ft.

### Screen Sizes

Min Panel	Max Single Panel
12"W x 12"H	120"W x 72"H (60 sq. ft.)

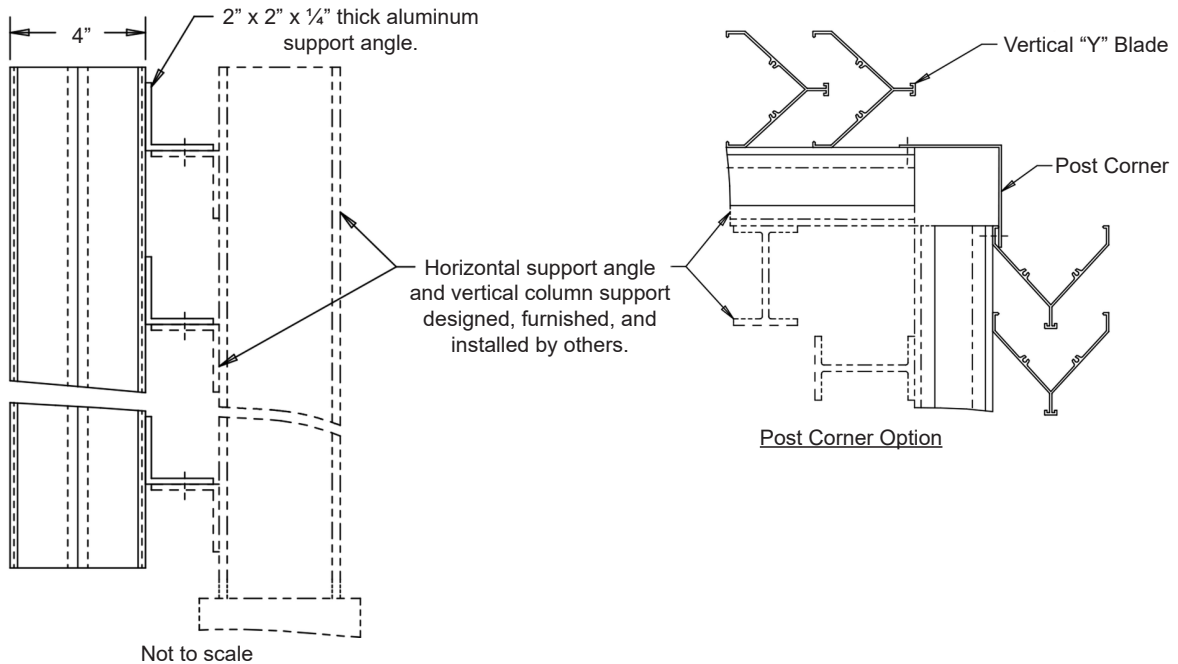
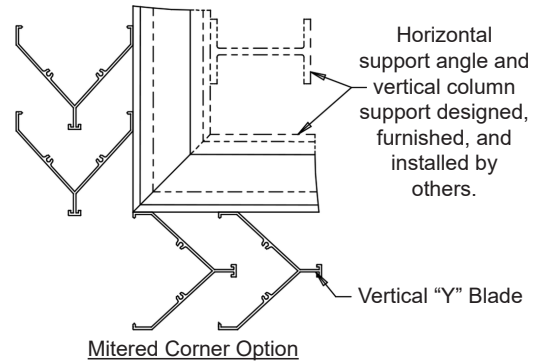

Item #	Qty	Height	Width	Mullion	Corner Type	Job:	Union Made
Arch. / Eng. :		EDR:		ECN:	Job:		
Contractor:							
Project:		Date:		DWN:	DWG:		