

**FEMA 361 Louver ▲ 5½" Deep ▲ Inverted V Blades ▲ Stationary ▲ Aluminum**

**STANDARD MATERIALS AND CONSTRUCTION**

- FRAME:** ¼" aluminum plate.
- BLADE:** ¼" structural aluminum angle.
- FRAME DEPTH:** 5½" deep
- SCREEN:** ½" x 0.051" expanded aluminum
- FREE AREA:** 49.3% - 7.89 sq. ft. (48" x 48" Louver)
- PSF RATING:** 266 PSF Design Load
- TEST METHODS:** ICC 500, FEMA 361, ASTM E 330, ASTM E 1886

**AVAILABLE FINISHES:** Mill, Kynar

**TEST METHODS**

**ICC 500-2008**, Standard for the Design and Construction of Storm Shelters.

**FEMA 361 3rd Edition**, Section B8 Test Methods for Impact and Pressure Testing.

**ASTM E 330-02**, Test Method for Structural Performance of Windows, Curtain Walls and Doors by Uniform Static Air Pressure Difference.

**ASTM E 1886-05**, Standard Test Method for Performance of Exterior Windows, Curtain Walls, Doors, and Impact Protective Systems Impacted by Missile and Exposed to Cyclic Pressure Differentials.

**NOTES**

1. Nominal deductions will be made to the opening size given.
2. Keep occupants and mechanical equipment to a minimum of 3 feet away from the louver during severe weather events.
3. Approximate shipping weight is 15.0 lbs./sq.ft.

**LOUVER SIZES**

Min Panel	Max Single Panel
12"W x 12"H	90"W x 90"H (Continuous Wide) 78"W x 90"H (Continuous High)

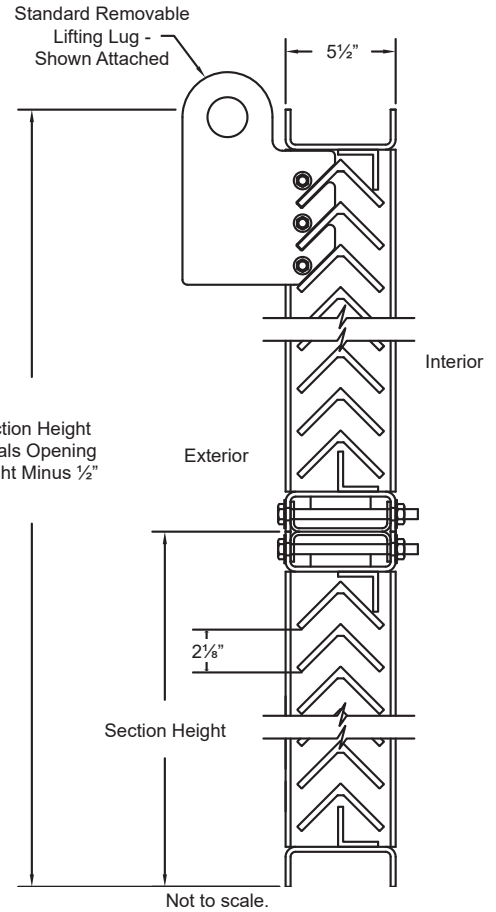

**Standard Mount**

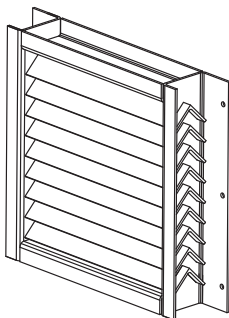

**Cantilevered Mount  
Flange at Jamb**

**Optional Flange Mounting or Channel Frame Mounting**

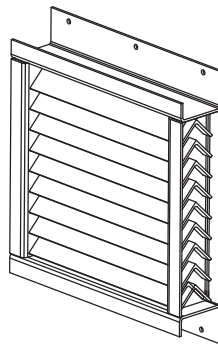

**Cantilevered Mount  
Flange at Head & Sill**

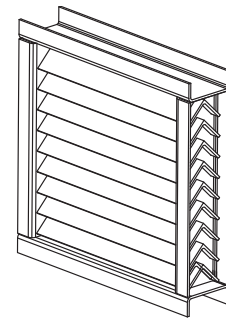

**Recessed Mount  
Channel Frame**

Item #	Qty	Width	Height	Width	Height	Mullion	Type	Location	Union Made
		Opening Size		Louver Size			Screens		
<b>Arch. / Eng. :</b>						<b>EDR:</b>	<b>ECN:</b>	<b>Job:</b>	
<b>Contractor:</b>									
<b>Project:</b>						<b>Date:</b>	<b>DWN:</b>	<b>DWG:</b>	



**PERFORMANCE DATA**

		Free Area sq.ft. (sq.m.)								
		Width in. (mm)								
		12" (305)	24" (610)	36" (914)	48" (1219)	60" (1524)	72" (1829)	78" (1981)	84" (2134)	90" (2286)
Height in. (mm)	12" (305)	0.23 (0.021)	0.79 (0.073)	1.34 (0.124)	1.88 (0.175)	2.44 (0.277)	2.99 (0.278)	3.26 (0.303)	3.53 (0.328)	3.72 (0.345)
	24" (610)	0.47 (0.043)	1.63 (0.152)	2.76 (0.256)	3.88 (0.361)	5.05 (0.469)	6.18 (0.574)	6.74 (0.626)	7.30 (0.678)	7.68 (0.714)
	36" (914)	0.71 (0.066)	2.48 (0.230)	4.18 (0.389)	5.89 (0.547)	7.66 (0.711)	9.36 (0.870)	10.22 (0.949)	11.07 (1.028)	11.65 (1.082)
	48" (1219)	0.95 (0.088)	3.32 (0.308)	5.61 (0.521)	7.89 (0.733)	10.26 (0.953)	12.55 (1.166)	13.69 (1.272)	14.84 (1.378)	15.61 (1.450)
	60" (1524)	1.19 (0.111)	4.16 (0.387)	7.03 (0.653)	9.90 (0.920)	12.87 (1.196)	15.74 (1.462)	17.17 (1.595)	18.61 (1.728)	19.58 (1.819)
	72" (1829)	1.43 (0.133)	5.01 (0.465)	8.46 (0.786)	11.90 (1.106)	15.48 (1.438)	18.93 (1.758)	20.65 (1.918)	22.37 (2.078)	23.54 (2.187)
	78" (1981)	1.56 (0.145)	5.43 (0.504)	9.17 (0.852)	12.91 (1.199)	16.78 (1.559)	20.52 (1.906)	22.39 (2.080)	26.14 (2.429)	27.51 (2.555)
	84" (2134)	1.68 (0.156)	5.85 (0.543)	9.88 (0.918)	13.91 (1.292)	18.08 (1.680)	22.11 (2.054)	24.13 (2.241)	28.03 (2.604)	27.51 (2.555)
	90" (2286)	1.80 (0.167)	6.27 (0.583)	10.59 (0.984)	14.91 (1.385)	19.39 (1.801)	23.71 (2.202)	25.86 (2.403)	27.16 (2.523)	29.49 (2.739)

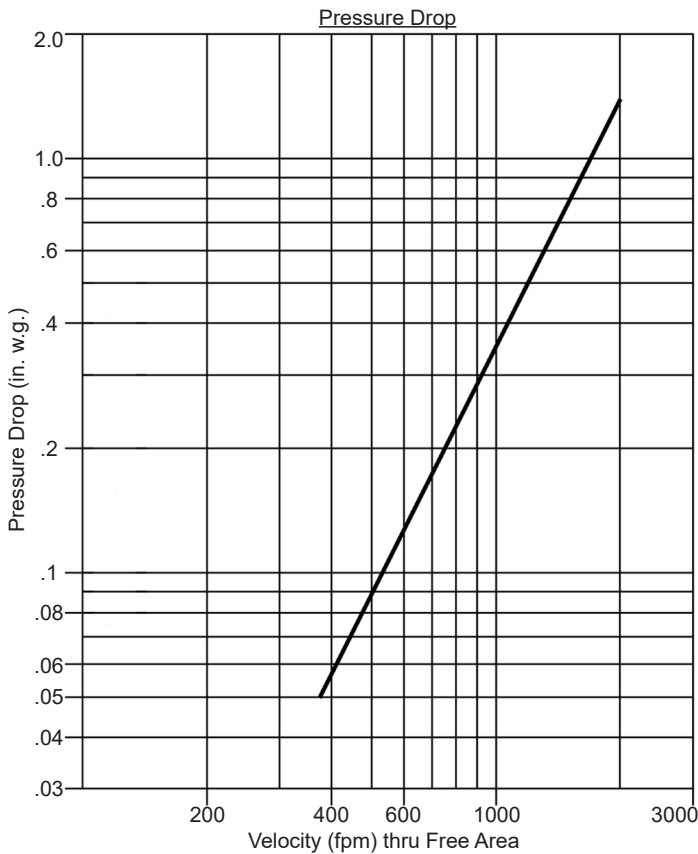

Standard Air - .075 lbs per cu.ft.  
 Ratings do not include the effect of a screen.  
 Tests based on a 48" x 48" test size.

**Fastener Schedule**

Anchor Type	Substrate	Minimum Embedment	Minimum Edge Dist.
(1) ½" x 3" Red Head LDT	CMU	2½"	3¼"
(1) ½" x 3" Red Head LDT	Concrete	2½"	3¼"
(2) 2" x ½" Grade 5 Bolt	Steel	Full	¾"

- (1) Concrete screws shall be Read Head LDT Zinc Coated Concrete Screws.
- (2) Bolts shall be a minimum Grade 5.

**Note to Occupants:**

Keep occupants and mechanical equipment to a minimum of 3 feet away from Model ALAF5 louvers during severe weather events.

## LOUVER JAMB MOUNTING DETAILS

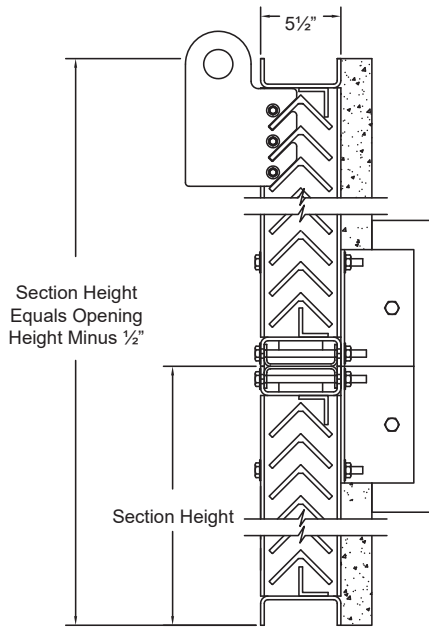

Model ALAF5  
Section View  
Recessed Frame Shown

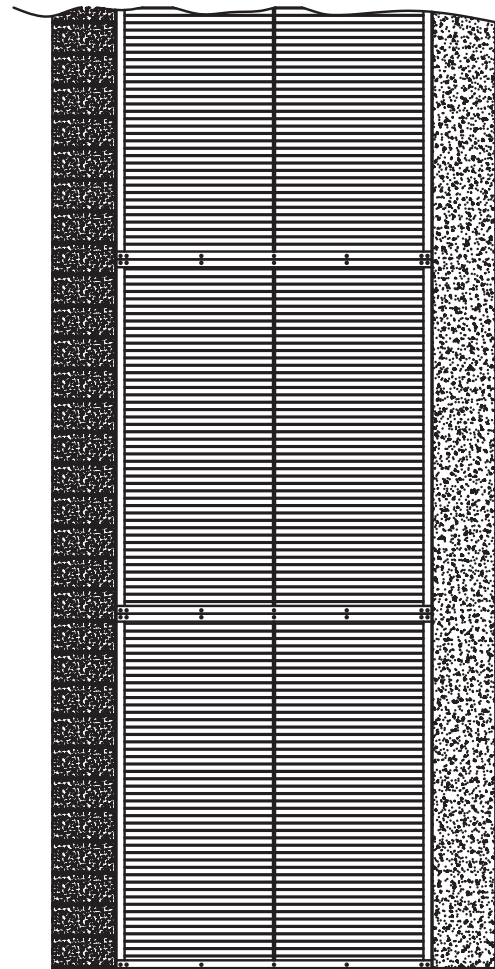

Model ALAF5  
Elevation

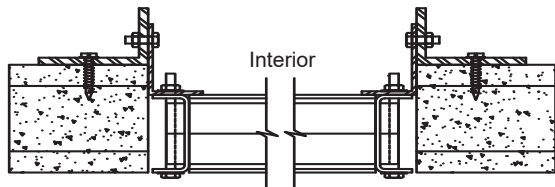

Model ALAF5  
Recessed Mount in Opening



Model ALAF5  
Plan View

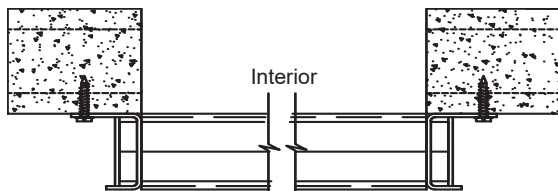

Model ALAF5  
Cantilevered at Opening

## LOUVER HEAD AND SILL MOUNTING DETAILS

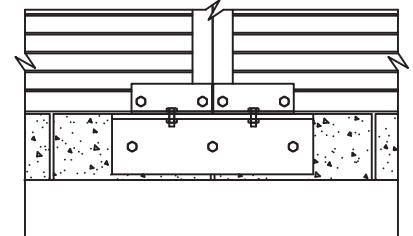
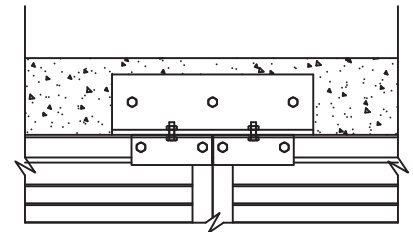
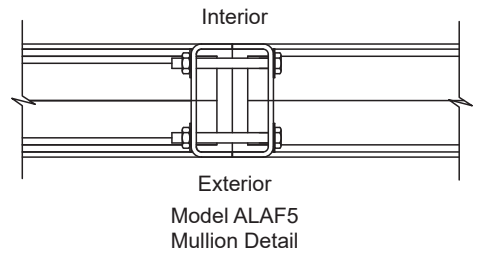
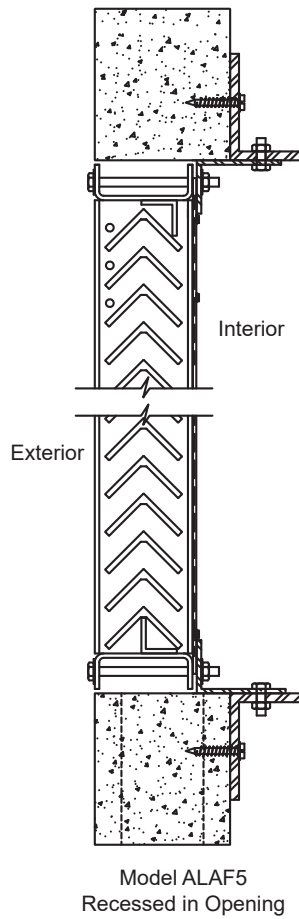
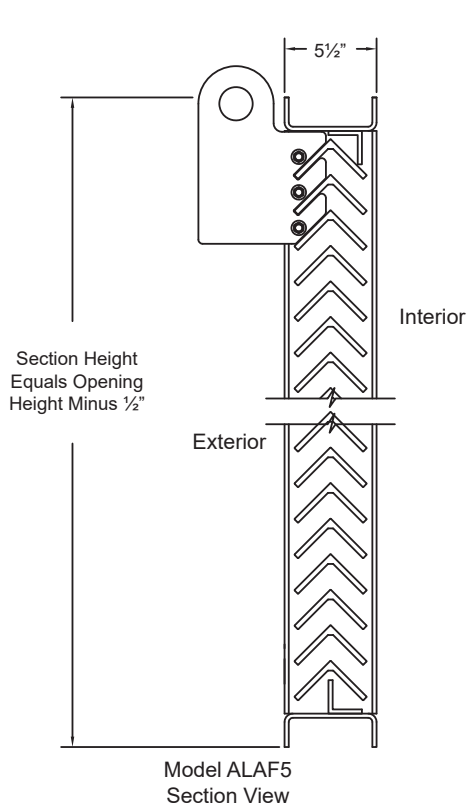

Model ALAF5 Recessed in Opening Head and Sill Detail

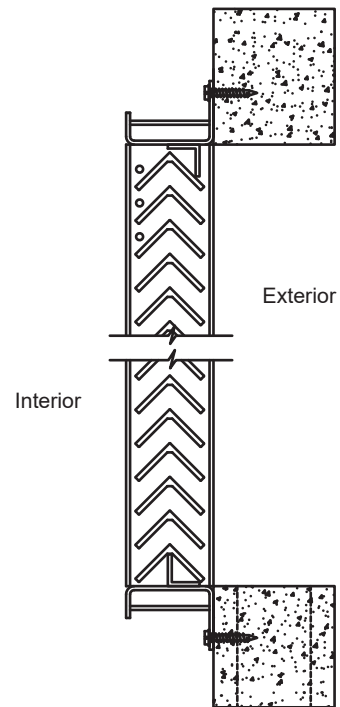
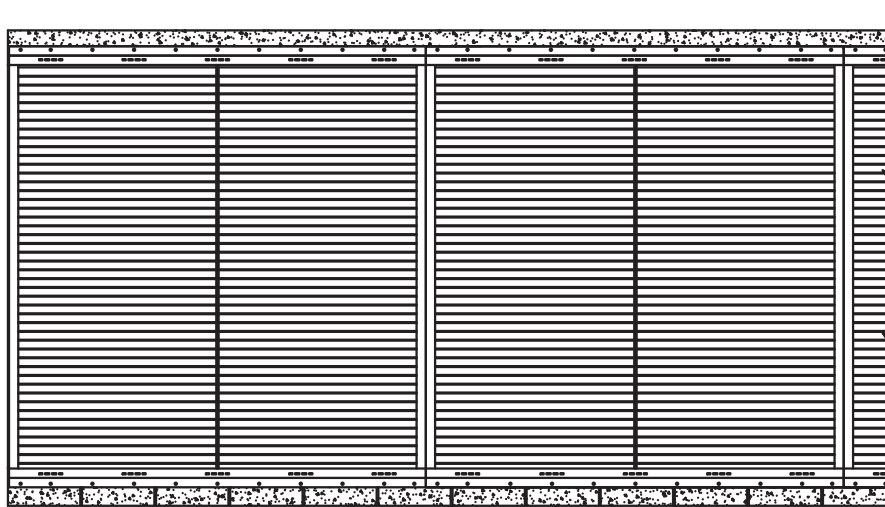

Model ALAF5 Cantilevered at Opening