

INSTALLATION INSTRUCTIONS FOR ARCHITECTURAL VERTICAL AND HORIZONTAL LOUVER MULLIONS

MULTI-WIDE LOUVERS WITH VERTICAL MULLION

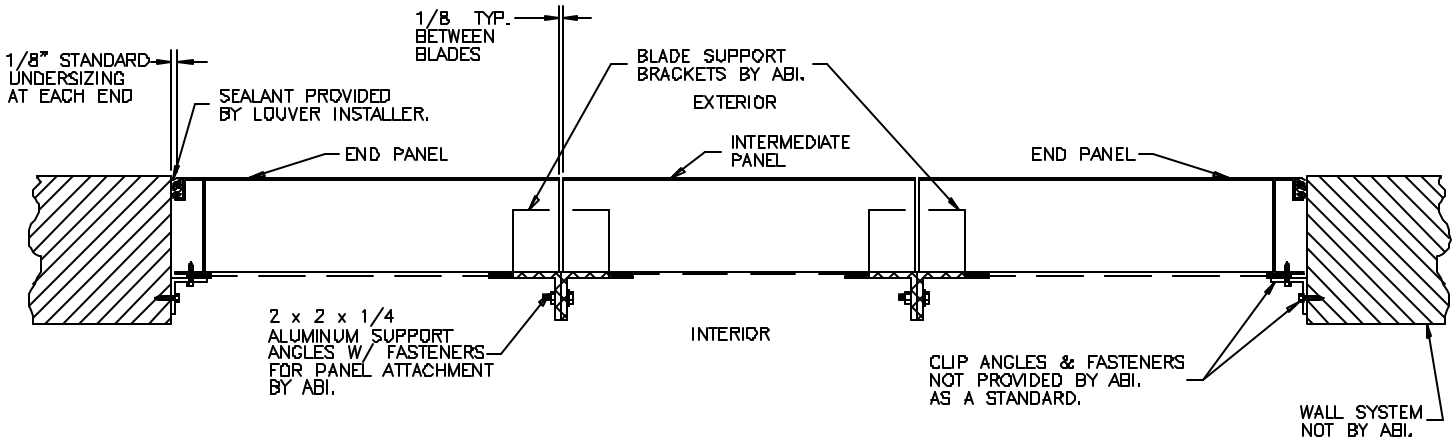

WHEN INSTALLING FROM INTERIOR SIDE OF OPENING, THE END PANELS ARE FABRICATED WITH VISIBLE JAMB SECTIONS ON ONE END AND A BLADE SUPPORT ANGLE ON THE OTHER. ALL INTERMEDIATE PANELS HAVE BLADE SUPPORT ANGLES LOCATED ON THE INTERIOR. THIS GIVES A CONTINUOUS BLADE APPEARANCE FROM THE EXTERIOR.

INSTALL ONE END PANEL FIRST BY MOUNTING CLIP ANGLES & FASTENERS TO THE LOUVER & WALL SYSTEM AROUND INTERIOR PERIMETER. CONTINUE INSTALLING WITH ADJACENT INTERMEDIATE PANELS BY BOLTING PANELS TOGETHER AT 2 x 2 x 1/4 SUPPORT ANGLES WITH FASTENERS PROVIDED BY ABI. EACH INTERMEDIATE PANEL ALSO NEEDS TO BE MOUNTED TO THE OPENING AT BOTH HEAD AND SILL FRAME MEMBERS. AFTER INSTALLING ALL INTERMEDIATE PANELS AS DESCRIBED FINISH BY INSTALLING OPPOSITE END PANEL AS DISCUSSED EARLIER. REFERENCE DRAWING 900 AND 900-1 FOR ADDITIONAL INFORMATION

MULTI-HIGH LOUVERS WITH HORIZONTAL MULLION

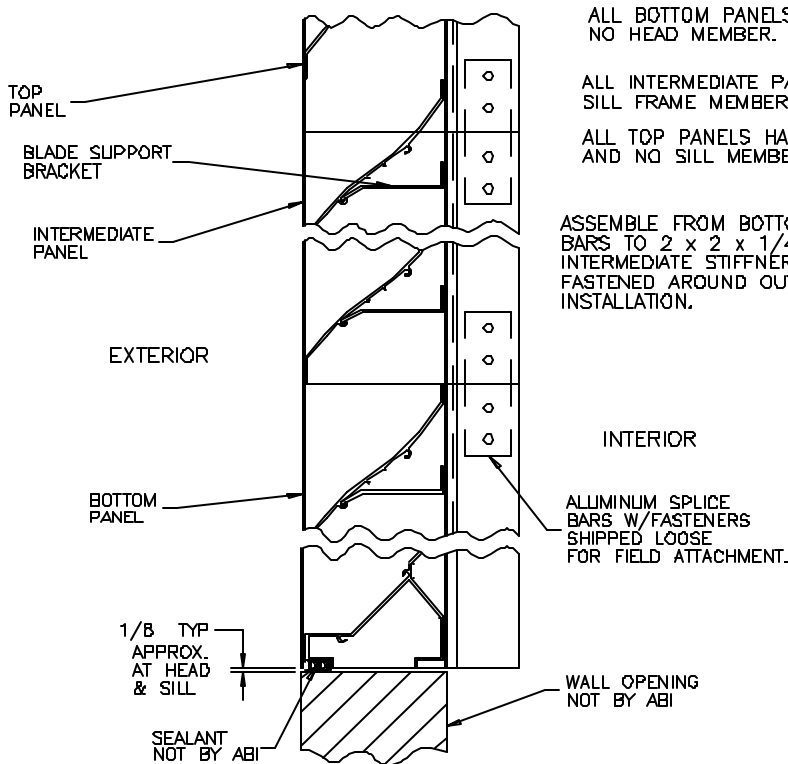

ALL BOTTOM PANELS HAVE A SILL FRAME MEMBER AND NO HEAD MEMBER.

ALL INTERMEDIATE PANELS HAVE NO HEAD OR SILL FRAME MEMBERS.

ALL TOP PANELS HAVE A HEAD FRAME MEMBER AND NO SILL MEMBER.

ASSEMBLE FROM BOTTOM TO TOP BY ATTACHING SPLICE BARS TO 2 x 2 x 1/4 SUPPORT ANGLES AND/OR 1-1/2 x 1-1/2 x 1/8 INTERMEDIATE STIFFNER ANGLES. EACH PANEL NEEDS TO BE INDIVIDUALLY FASTENED AROUND OUTER PERIMETER TO THE OPENING FOR PROPER INSTALLATION.

OPENINGS THAT REQUIRE MULTIPLE LOUVER PANELS IN BOTH WIDTH AND HEIGHT WILL REQUIRE INTERNAL STRUCTURAL SUPPORTS. IT IS RECOMMENDED THAT LARGE OPENINGS BE DIVIDED WITH STRUCTURAL MEMBERS SO THAT THE LOUVERS WILL SPAN EITHER WIDTH OR HEIGHT WITH A SINGLE PANEL. UNUSUALLY HIGH WIND LOADING MAY REQUIRE STRUCTURAL SUPPORTS ON NON-MULTIPLE WIDE AND MULTIPLE HIGH ASSEMBLIES. STRUCTURAL SUPPORTS AND MOUNTING ACCESSORIES ARE NOT SUPPLIED AS A STANDARD.

abi

air balance, inc.

A MESTEK COMPANY

7301 INTERNATIONAL DRIVE HOLLAND, OHIO

MULLION INSTALLATION INSTRUCTIONS

DRN. BY	LMG	DWG. NO.	REV.
DATE	11/10/99	22466-ABI	

AUTOCAD: ABI22466

TYPICAL ELEVATION SECTION VIEW